

Before you use your epinephrine auto-injector, make sure the medicine is ready when you need it. Look at it regularly, and if the medicine in the epinephrine auto-injector is cloudy, discolored, has particles in it, or if the expiration date has passed, the epinephrine auto-injector should be replaced.<sup>4</sup> Follow the color-coded instructions on the device.

Do **NOT** remove **GRAY** caps until you are ready to use the epinephrine auto-injector.<sup>4</sup>

The following instructions should be followed for both epinephrine auto-injector 0.15 mg and epinephrine auto-injector 0.3 mg.<sup>4</sup>

### Step A

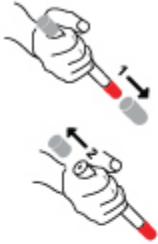

- Pull off **GRAY** end cap with the [1]; you will now see a **RED** tip. Never put thumb, finger, or hand over the **RED** tip.
- Pull off **GRAY** end cap with [2].

### Step B



- Put the **RED** tip against the middle of the outer side of your thigh (upper leg) as shown. It can go through clothes.
- Press down hard until the needle enters your thigh (upper leg) through your skin. Hold it in place while slowly counting to 10.
- Remove the epinephrine auto-injector from your thigh.
- Check the **RED** tip. If the needle is exposed, you received the dose. If the needle is not visible, repeat Step B.

### Step C



**Get emergency medical help right away: Call 911.**